

EtherneTV Portal Server

Enterprise Video Delivery Systems

Enterprise Video Delivery Systems

Take control of your enterprise video with VBrick's Media Management Portal, the cornerstone of our IP Video distribution solution. The Portal allows you to manage your video activities seamlessly with device, system and user management, a scheduling interface, and viewing portal. You can access all live IP Video channels and on-demand servers – at any time or from any place. And it integrates with your current enterprise infrastructure – IP network, content/learning management systems, LDAP/Active Directory, and Single Sign-On.

Capabilities:

The EtherneTV Portal Server supports automated live channel guides and navigation to video on-demand assets. Access control functions enable administrators to assign which videos may be viewed at the group and user level.

Multi-Video Format – Supports H.264, Windows Media®, MPEG-1,2, and 4 formats, 4:3 and 16:9 aspect ratios, PAL and NTSC formats, and full screen video (up to High Definition quality)

Multiple Video Windows – View multiple simultaneous video windows with complete access logging of all opened windows

Bookmarks and Playlists – Quickly bookmark any location in a video and create playlists of multiple bookmarks

Access Control – Specify and control which users may access which video assets with integration into Active Directory or other LDAP directory services

Recording – Record up to two simultaneous video streams and forward them to a VOD server for retrieval at a later time

VOD Management – Manages access and generates directories of the assets stored on multiple VOD servers

SSL/TLS Security – Provides secure encrypted access to all end user pages

Dynamic Channel Guide – Automatically generate a listing of all available live video and even display television channel program listings (through the optional EtherneTV Channel Guide)

Reporter Module – Optional Reporter module allows customers to create graphical usage reports which provide administrators with a wealth of information on system use

Backup Module – Optional Backup module delivers increased EtherneTV system availability through the addition of a secondary or “warm backup” server

Product Datasheet



Compatibility:

- LDAP/Active Directory directory services
- Windows-based PCs
- Macintosh computers

Interoperability:

- EtherneTV Scheduler
- EtherneTV Network Video Recorder (NVR)
- EtherneTV Channel Guide
- EtherneTV Reporter
- EtherneTV Backup
- EtherneTV IPR – low cost EtherneTV user interface and video decoding (MPEG)
- EtherneTV WM-IPR – low cost video EtherneTV user interface and Windows Media video decoding
- Amino 110 STB – low cost video decoding (MPEG-2)
- VBrick VOD-W and VOD-WM Video On-Demand Servers
- Windows Media Player
- Streamplayer software for desktop video decoding
- VBrick H.264, Windows Media, MPEG-2, and MPEG-4 appliances
- VBPresenter

Product Datasheet

Models:

- **8000-0049** EtherneTV Portal Server, Hardware and Software configuration
- **7500-0120** EtherneTV Portal Server software
- **7510-0120** EtherneTV Portal Server upgrade

Benefits:

- An intuitive interface that enables access to all EtherneTV Portal Server functions
- Ubiquitous viewing from Windows PCs, Macs, IPR's and Set Top Boxes
- Access to live and stored video assets
- Reliable Infrastructure for live video is sourced through industry leading VBrick appliances
- Administrative controls that enable ease of setup and configuration and controlled access

EtherneTV System

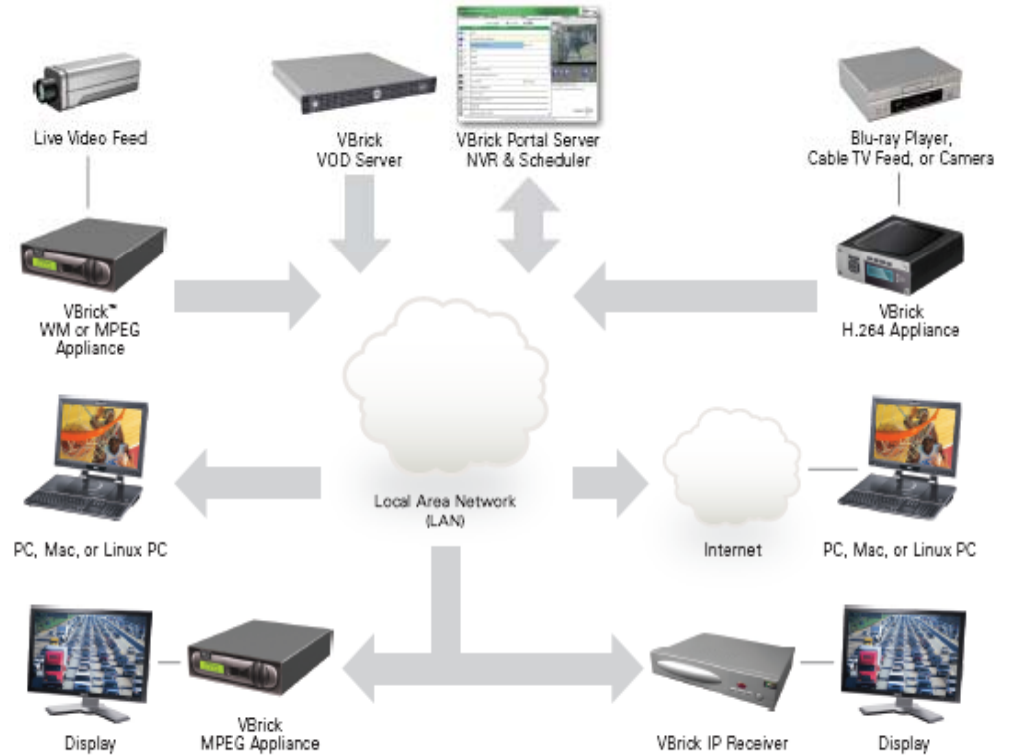

FEATURES AND SPECIFICATIONS

PC End User Requirements	Windows 2000, XP (Service Pack 2 or higher), or Vista Microsoft Internet Explorer 6.0 or higher; or Firefox 3.0 or higher Windows Media Player 9.0 or higher
Macintosh End User Requirements	Mac OS X 10.3 or higher Firefox for Macintosh 3.0 or higher; or Safari 1.2 or higher StreamPlayer for Mac; or QuickTime player 7.0 or higher (H.264 and MPEG-4 only)
System Requirements	Windows Server 2003 (Web Edition or Standard Edition with Service Pack 2) Pentium IV or Xeon Processor 1.26 GHz Minimum (2 GHz or higher recommended) RAM 512 MB Minimum (2 GB or more recommended) Hard Drive 36 GB Minimum (larger for frequent recording)

LTI DataComm

23020 Eaglewood Ct. #100
Sterling, VA 20166
www.ltidata.com
800-677-5050